



CLASS A	ANNUAL ENERGY 58 kWh
FINO A - UP TO 900 m ³ /h	MAX PRESSURE 590 Pa

Rodia isola

Diam.
30
cm



CARATTERISTICHE - FEATURES

Misura - Size	Diam 30 cm
Materiale - Material	Struttura inox satinato o verniciata bianca, piano inferiore in alluminio verniciato body in Scotch brite St/steel or white painted, lower panel in aluminium painted
Controlli - Controls	pulsantiera elettronica retroilluminata backlit electronic control
Funzioni - Functions	4 velocità con intensiva, timer, spegnimento automatico, ind.pulizia/sost. filtri 4 speed with boost, timer, automatic switch off, filter cleaning and replacement indicator
Luci Lights	LED 2x1W LED 2x1W
Aspirazione Extraction	perimetrale con pannello apribile perimetral with openable panel
Uscita aria - Duction	120 - 150 mm con valvola di non ritorno 120 - 150 with check valve
Tipo d'uso - Type	filtrante o aspirante Extractor or filter
Filtro antigrasso Grease filter	in alluminio multistrato lavabile in aluminium multilayer, washable
Minima distanza Min. Distance from hob	65 cm

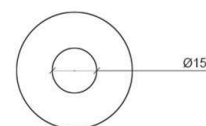
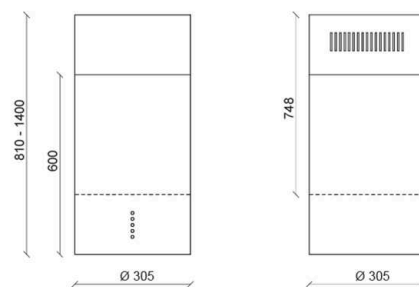

DIMENSIONI SCATOLA - BOX SIZE 36 x 96 x 46 cm - 24 Kg

FILTRI OPTIONAL - OPTIONAL FILTERS

Total grease filter filtro aggiuntivo antigrassi 95% (A*)	02TG190170
Total Grease filter additional grease filter 95% (A*)	
Filtro antiodori Charcoal filter	02FCT190170
Hi-Filter filtro antiodore di lunga durata, lavabile e rigenerabile Hi-Filter long-lasting, washable and regenerable odor filter	02HF190170

VERSIONI - VERSION

- cm. 30 - Inox, vetro bianco - St/Steel, white glass - 700m³/h
01RODIS305ST70
- cm. 30 - Inox, vetro bianco - St/Steel, white glass - 800m³/h
01RODIS305ST80
- cm. 30 - Inox, vetro bianco - St/Steel, white glass - 900m³/h
01RODIS305ST90
- cm. 30 - bianca, vetro bianco - white, white glass - 700m³/h
01RODIS305WH70
- cm. 30 - bianca, vetro bianco - white, white glass - 800m³/h
01RODIS305WH80
- cm. 30 - bianca, vetro bianco - white, white glass - 900m³/h
01RODIS305WH90